

Commercial Experience

Project:

Bournemouth Capacity Development

Location:

Christchurch, Dorset

Client:

Manchester Airport Developments

Completion:

April 2010

Anticipated

Construction Cost:

£45,000,000

Form of Contract:

JCT Design & Build 2005 and
NEC 2 Option A

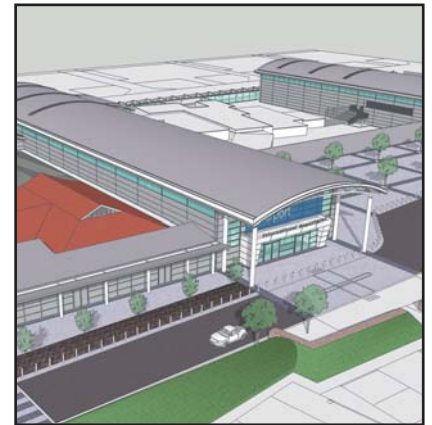

Roles & Responsibilities:

P H Warr plc has been appointed to provide Quantity Surveying and Health & Safety CDM Co-ordination services on the major redevelopment of Bournemouth Airport.

Scheme:

The £45 million scheme centres on expanding and updating the existing terminal building, providing a new arrivals building and energy centre, landscaping and works to upgrade the airport infrastructure along with an additional c.3,000 car park spaces.

It has been proposed to effectively double the size of the terminal to improve conditions for the current usage of almost one million passengers a year and to cater for a predicted three-fold increase over the next decade.

CHARTERED QUANTITY SURVEYORS

CHARTERED BUILDING SURVEYORS

HEALTH AND SAFETY

ENVIRONMENTAL SURVEYORS

BESPOKE & SPECIALIST SERVICES



PH Warr plc
Property & Construction Surveyors